

Specifications:
Housing: LCP UL94-V0 Color: Nature
Cove: LCP UL94-V0 Color: Black
Contact: Phosphor Bronze
Operating Voltage: 50V AC/DC
Current Rating: 0.5A AC/DC
Withstand Voltage: 250V AC/Minute
Contact Resistance: $\leq 20m\Omega$
Insulation resistance: $\geq 100M\Omega$
Operating Temperature: $-25^{\circ}C \sim +85^{\circ}C$

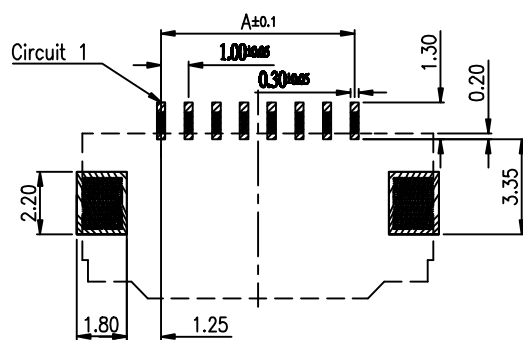

RECOMMENDED PC BOARD PATTERN DIM.(REF.)

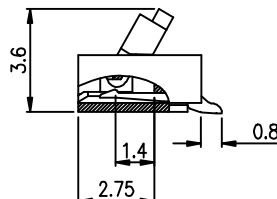
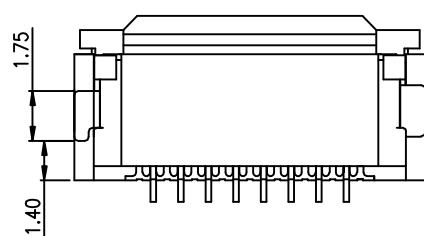
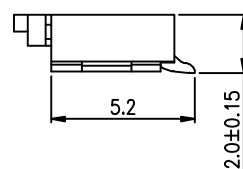
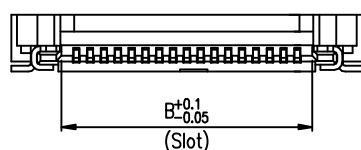
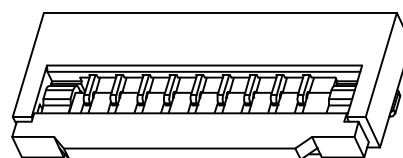
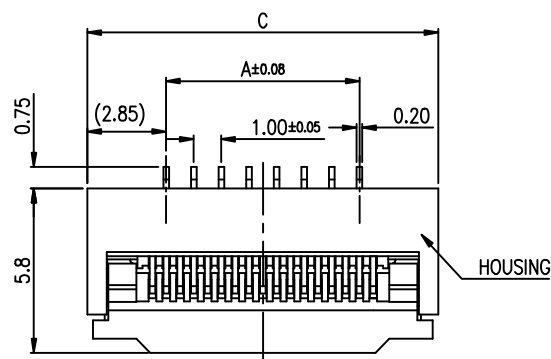
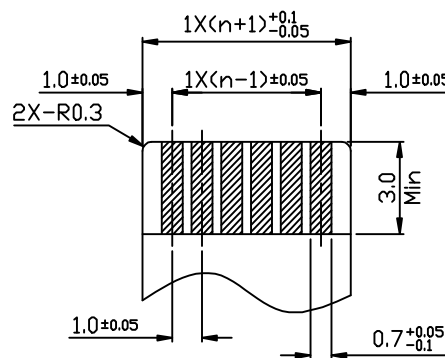

APPLICABLE FPC RECOMMENDED DIM.

CKT	Dim A	Dim B	Dim C
3	2.00	4.06	7.7
4	3.00	5.06	8.7
5	4.00	6.06	9.7
6	5.00	7.06	10.7
7	6.00	8.06	11.7
8	7.00	9.06	12.7
9	8.00	10.06	13.7
10	9.00	11.06	14.7
11	10.00	12.06	15.7
12	11.00	13.06	16.7
13	12.00	14.06	17.7
14	13.00	15.06	18.7
15	14.00	16.06	19.7
16	15.00	17.06	20.7
17	16.00	18.06	21.7
18	17.00	19.06	22.7
19	18.00	20.06	23.7
20	19.00	21.06	24.7
21	20.00	22.06	25.7
22	21.00	23.06	26.7
23	22.00	24.06	27.7
24	23.00	25.06	28.7
25	24.00	26.06	29.7
26	25.00	27.06	30.7
27	26.00	28.06	31.7
28	27.00	29.06	32.7
29	28.00	30.06	33.7
30	29.00	31.06	34.7

一般公差 TOLERANCES X. ±0.40 XX ±0.20 .X ±0.30 .XXX ±0.10 ANGLES ±2°		深圳市宏利电子有限公司 Shenzhen Holy Electronic Co.,Ltd	
检验尺寸标示 SYMBOLS \odot \ominus INDICATE CLASSIFICATION DIMENSION \odot MARK IS CRITICAL DIM. \ominus MARK IS MAJOR DIM.			
表面处理 (FINISH)		品名 FPC1.0mm - nP H2.0 翻盖下接	核准 (APPD) Rigo Lu
比例 (SCALE) 1:1	单位 (UNITS) mm	张数 (SHEET) 1 OF 1	尺寸 (SIZE) A4 版次 (REV) 0

修订	修改摘要	日期	签名
REV	REVISION DESCRIPTION	DATE	SIGNATURE